

NOTE:

RIVETS MUST NOT ENTER THE INTERIOR OF THE FLIGHT CASE!

Pos.	Quantity	Unit	Part name	Material	ID			
<div>Date05.12.2024.</div> <div>Drawn by</div> <div>Checked</div> <div>Approved</div>				Title: <div>MO-310 Case (8) Astera Quick Spot</div>				
				Project ID:		Scale:	Sheet:	F: A4
				760188986		1:10	1/32	L: 11

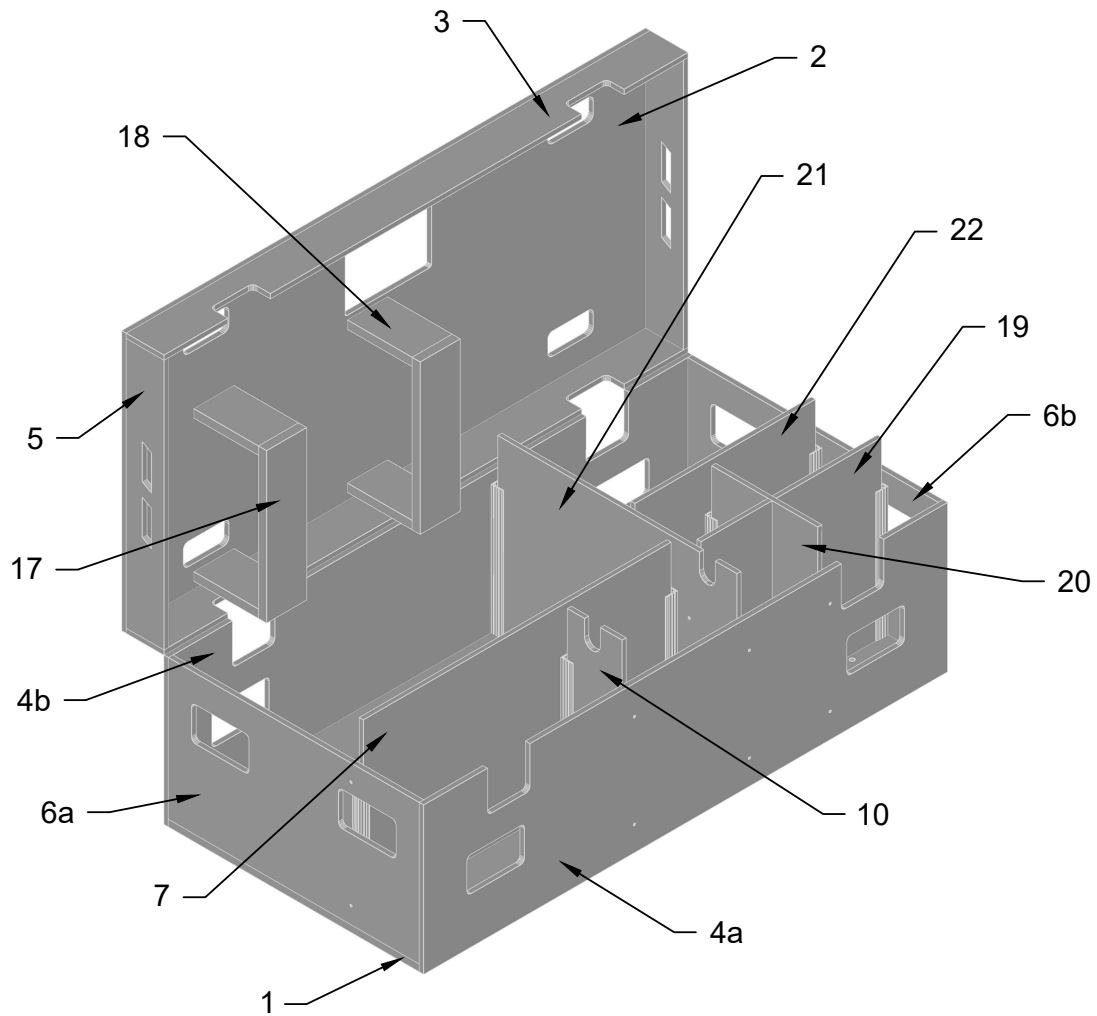

22	1	pcs	Lenghtwise Compartment next to Crate	9 mm Phenolic Birch Wood Panels	56-001
21	1	pcs	Large Crosswise Compartment	9 mm Phenolic Birch Wood Panels	56-001
20	1	pcs	Crosswise Cross Lap Compartment	9 mm Phenolic Birch Wood Panels	56-001
19	1	pcs	Lenghtwise Cross Lap Compartment	9 mm Phenolic Birch Wood Panels	56-001
18	4	pcs	Bench Supports in the Lid	18 mm Phenolic Birch Wood Panels	56-007
17	2	pcs	Bench Panel in the Lid	18 mm Phenolic Birch Wood Panels	56-007
10	1	pcs	Left narrow compartment	9 mm Phenolic Birch Wood Panels	56-001
07	1	pcs	Compartment with circular opening	9 mm Phenolic Birch Wood Panels	56-001
06b	1	pcs	Right Panel	9.6 mm Birch Wood Panels with Black Rigid PVC Laminate	SD-9.60-RAL9011
06a	1	pcs	Left Panel	9.6 mm Birch Wood Panels with Black Rigid PVC Laminate	SD-9.60-RAL9011
05	2	pcs	Side parts of the Lid	9.6 mm Birch Wood Panels with Black Rigid PVC Laminate	SD-9.60-RAL9011
04b	1	pcs	Back Panel	9.6 mm Birch Wood Panels with Black Rigid PVC Laminate	SD-9.60-RAL9011
04a	1	pcs	Front Panel	9.6 mm Birch Wood Panels with Black Rigid PVC Laminate	SD-9.60-RAL9011
03	2	pcs	Front / Back side of the Lid	9.6 mm Birch Wood Panels with Black Rigid PVC Laminate	SD-9.60-RAL9011
02	1	pcs	Top of the Lid	9.6 mm Birch Wood Panels with Black Rigid PVC Laminate	SD-9.60-RAL9011
01	1	pcs	Bottom Panel	15 mm Phenolic Birch Wood Panels	56-005
Pos.	Quantity	Unit	Part name	Material	ID

			Title:			
Date	05.12.2024.		MO-310 Case (8) Astera Quick Spot			
Drawn by						
Checked			Project ID: 760188986			
Approved			Scale: 1:10		Sheet: 2/32	F: A4 L: 11

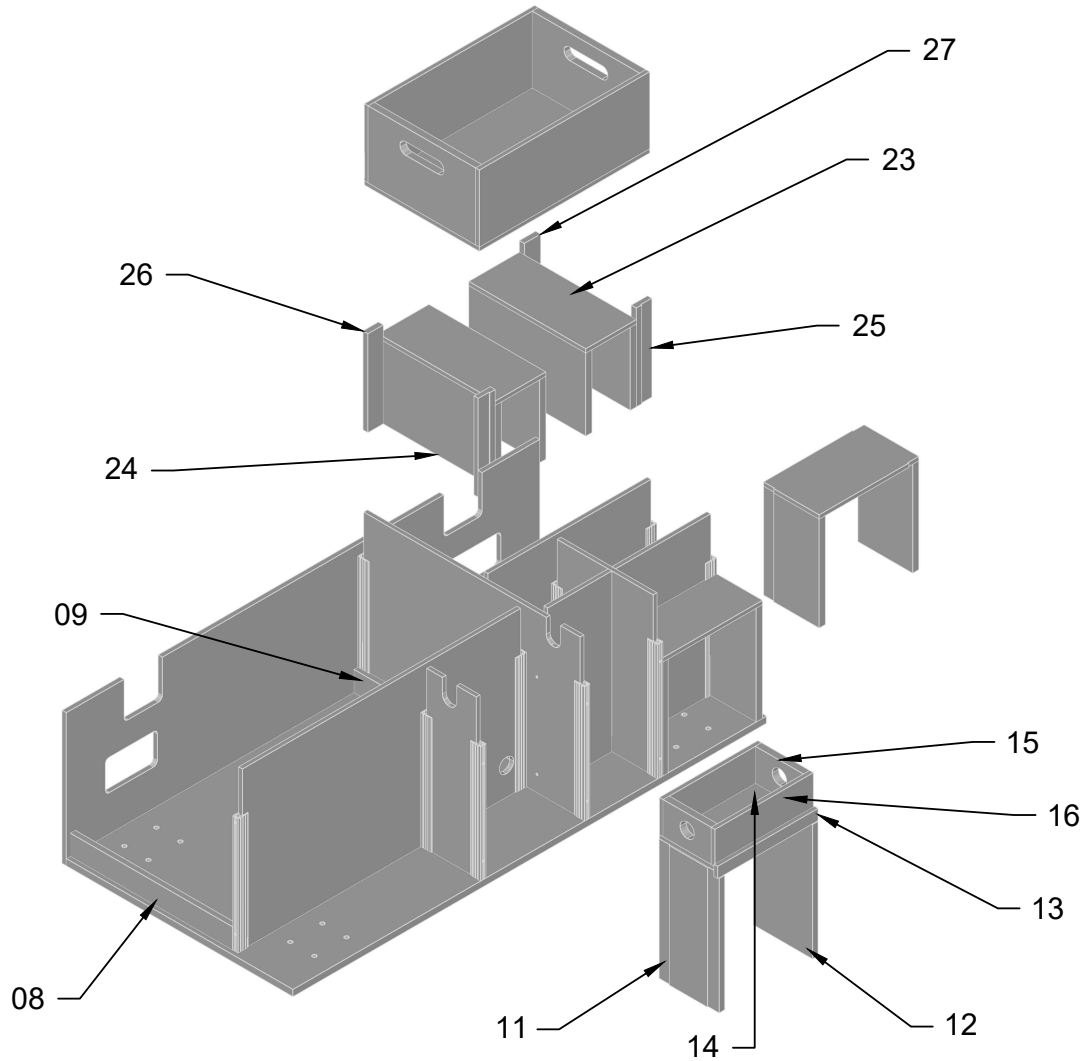

27	1	pcs	Right rear Support of the Large Crate	12 mm Raw Birch Wood Panels	012-R
26	1	pcs	Left rear Support of the Large Crate	12 mm Raw Birch Wood Panels	012-R
25	2	pcs	Front Supports of the Large Crate	12 mm Raw Birch Wood Panels	012-R
24	4	pcs	Side parts of Structural Support	15 mm Phenolic Birch Wood Panels	56-005
23	2	pcs	Top part of Structural Support	9 mm Phenolic Birch Wood Panels	56-001
16	2	pcs	Front / Back part of the Small Crate	9 mm Phenolic Birch Wood Panels	56-001
15	2	pcs	Side parts of the Small Crate	15 mm Phenolic Birch Wood Panels	56-005
14	1	pcs	Bottom of the Small Crate	9 mm Phenolic Birch Wood Panels	56-001
13	1	pcs	Spacer next to Edge Extrusion	9 mm Phenolic Birch Wood Panels	56-001
12	1	pcs	Right Support under small Crate	15 mm Phenolic Birch Wood Panels	56-005
11	1	pcs	Left Support under small Crate	15 mm Phenolic Birch Wood Panels	56-005
09	1	pcs	Right Leveling Supplement	12 mm Raw Birch Wood Panels	012-R
08	1	pcs	Left Leveling Supplement	12 mm Raw Birch Wood Panels	012-R
Pos.	Quantity	Unit	Part name	Material	ID

			Title:						
Date	05.12.2024.		MO-310 Case (8) Astera Quick Spot						
Drawn by									
Checked									
Approved									
			Project ID:		760188986	Scale:		Sheet:	F: A4
						1:10		3/32	L: 11

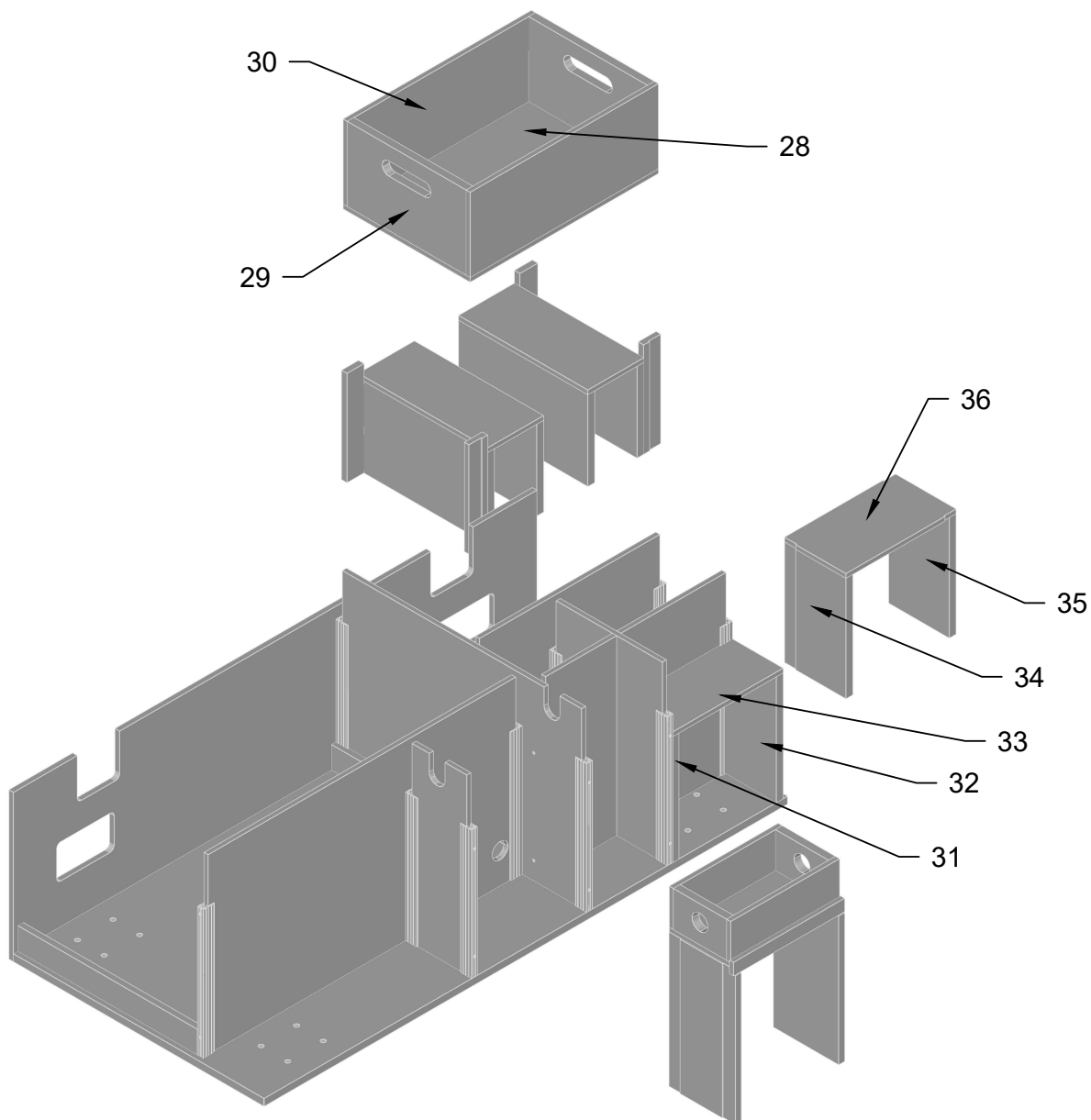

36	1	pcs	Plank under Grooved Foam	9 mm Phenolic Birch Wood Panels	56-001
35	1	pcs	Right Support under Grooved Foam	15 mm Phenolic Birch Wood Panels	56-005
34	1	pcs	Left Support under Grooved Foam	15 mm Phenolic Birch Wood Panels	56-005
33	1	pcs	Plank under Perforated Foam	9 mm Phenolic Birch Wood Panels	56-001
32	1	pcs	Right Support under Perforated Foam	15 mm Phenolic Birch Wood Panels	56-005
31	1	pcs	Left Support under Perforated Foam	15 mm Phenolic Birch Wood Panels	56-005
30	2	pcs	Front / Back part of the Large Crate	9 mm Phenolic Birch Wood Panels	56-001
29	2	pcs	Side parts of the Large Crate	15 mm Phenolic Birch Wood Panels	56-005
28	1	pcs	Bottom of the Large Crate	9 mm Phenolic Birch Wood Panels	56-001
Pos.	Quantity	Unit	Part name	Material	ID

		Title:			
		MO-310 Case (8) Astera Quick Spot			
Date	05.12.2024.			Project ID:	760188986
Drawn by				Scale:	1:10
Checked				Sheet:	4/32
Approved				F:	A4
				L:	11

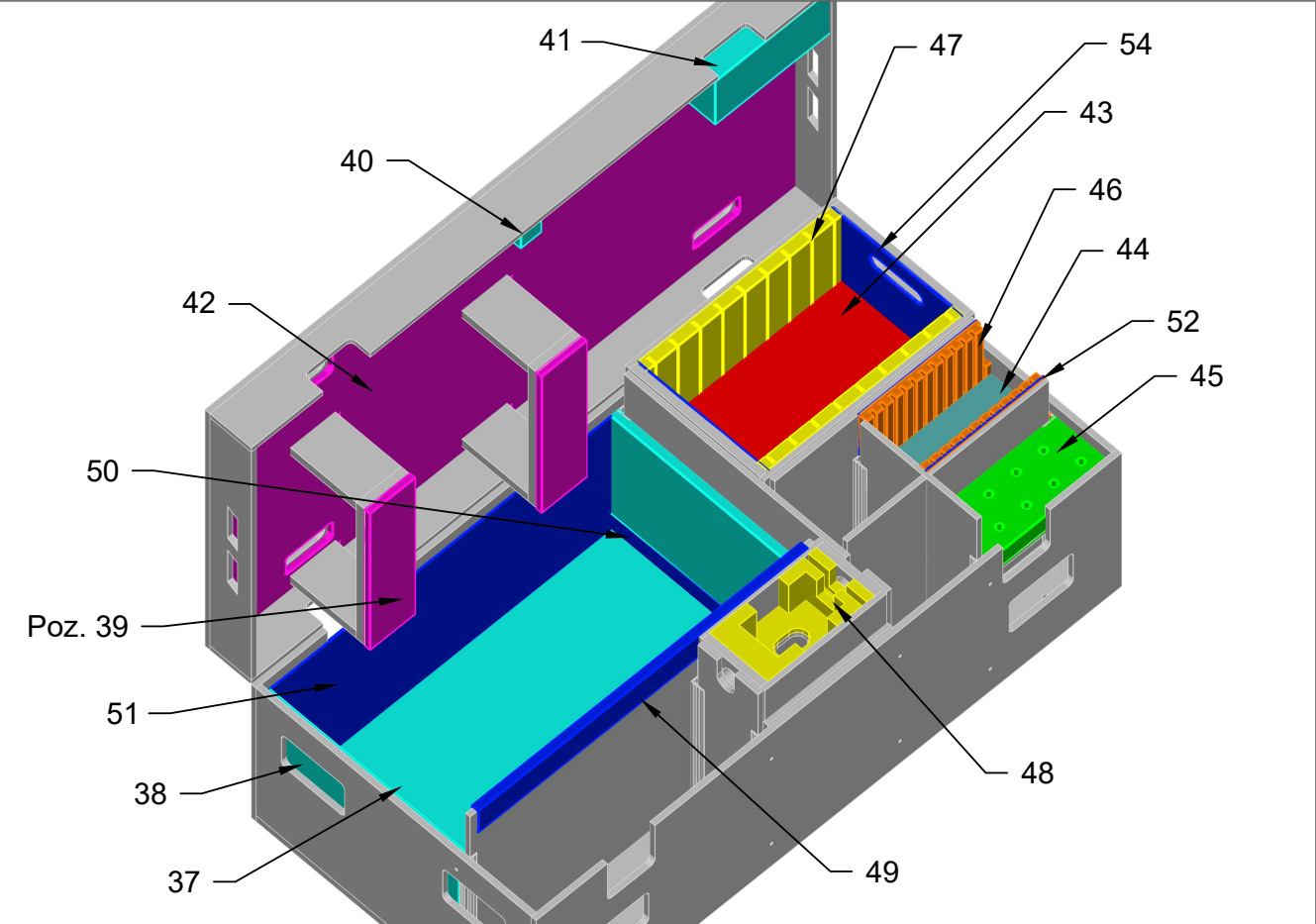

54	2	pcs	268 x 166	2mm thick self-adhesive felt	319761
52	2	pcs	237 x 146	2mm thick self-adhesive felt	319761
51	1	pcs	717 x 290	2mm thick self-adhesive felt	319761
50	2	pcs	405 x 50	3.5mm thick self-adhesive felt	365295
49	1	pcs	663 x 450	2mm thick self-adhesive felt	319761
48	1	pcs	215 x 120	Plastazon LD 45, thickness 80 mm	PE-MG8780/45
47	2	pcs	394 x 161	Plastazon LD 45, thickness 20 mm	PE-MG8720/45
46	2	pcs	253 x 126	15mm Thick Black POLYBloc Foam with grooves	PE-MG8715G
45	1	pcs	250 x 116	35mm Thick Black POLYBloc Foam	PE-MG8035
44	1	pcs	250 x 140	20mm Thick Black POLYBloc Foam	PE-MG8020
43	1	pcs	394 x 268	5mm Thick Black POLYBloc Foam	PE-MG8005
42	1	pcs	1164 x 569	20mm Thick Black POLYBloc Foam	PE-MG8020
41	1	pcs	240 x 105	70mm Thick Black POLYBloc Foam	PE-MG8070
40	1	pcs	90 x 40	20mm Thick Black POLYBloc Foam	PE-MG8020
39	2	pcs	336 x 90	10mm Thick Black POLYBloc Foam	PE-MG8010
38	2	pcs	407 x 240	15mm Thick Black POLYBloc Foam	PE-MG8015
37	1	pcs	695 x 410	10mm Thick Black POLYBloc Foam	PE-MG8010
Pos.	Quantity	Unit	Dimension	Material	ID
			Title:		
			MO-310 Case (8) Astera Quick Spot		
Date			Project ID:		
05.12.2024.			760188986		
Drawn by			Scale:		
			1:10		
Checked			Sheet:		
			18/32		
Approved			F: A4		
			L: 11		

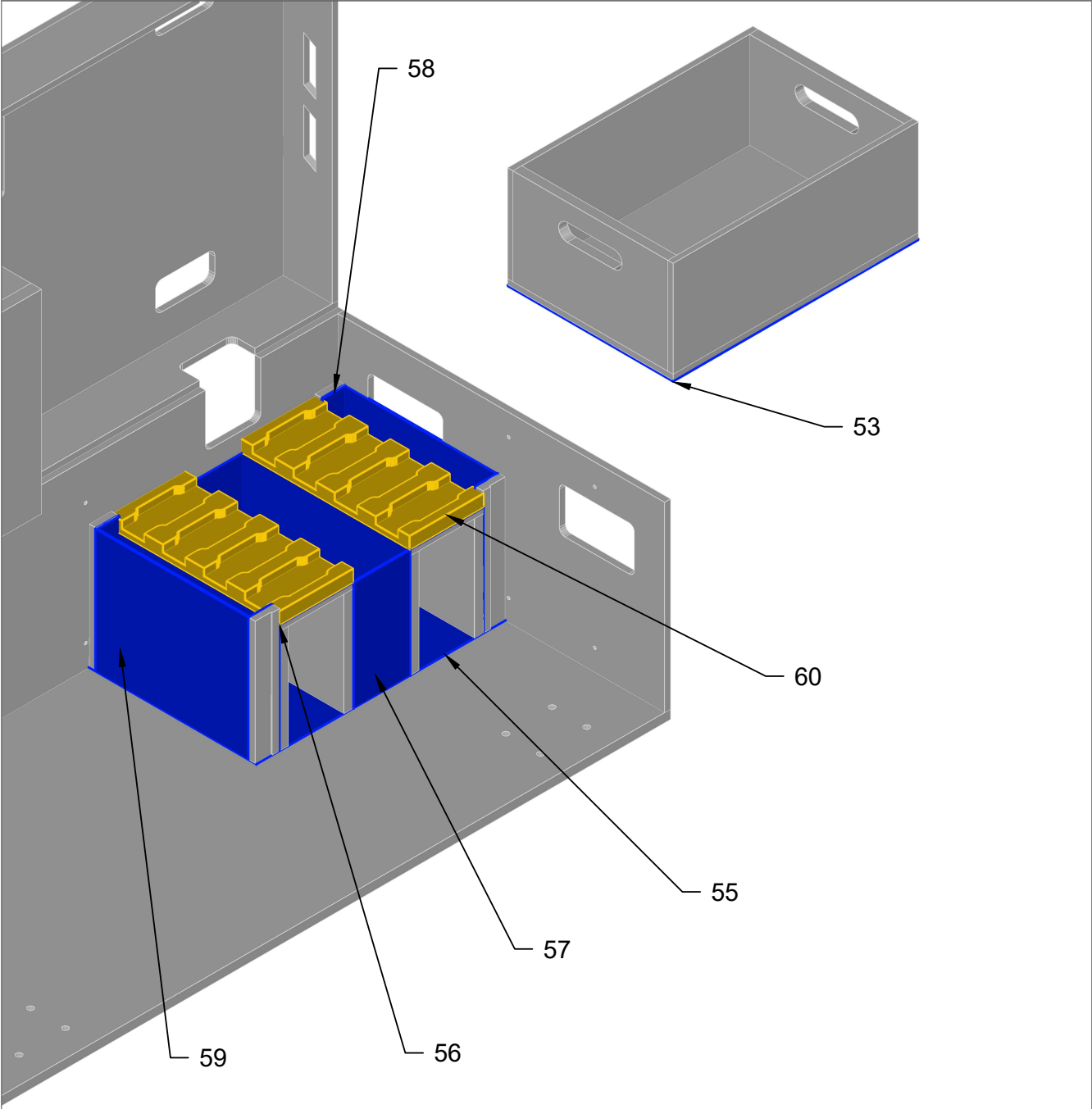

60	2	pcs	291 x 128	Plastazon LD 45, Thickness 20 mm	PE-MG8720/45
59	2	pcs	268 x 213	2mm thick self-adhesive felt	319761
58	4	pcs	213 x 40	2mm thick self-adhesive felt	319761
57	2	pcs	190 x 98	2mm thick self-adhesive felt	319761
56	2	pcs	506 x 291	2mm thick self-adhesive felt	319761
55	1	pcs	432 x 291	2mm thick self-adhesive felt	319761
53	1	pcs	424 x 286	2mm thick self-adhesive felt	319761
Pos.	Quantity	Unit	Dimension	Material	ID
			Title:		
Date			MO-310 Case (8) Astera Quick Spot		
05.12.2024.					
Drawn by					
Checked					
Approved					
			Project ID:	760188986	Scale: 1:10
					Sheet: 19/32
					F: A4
					L: 11

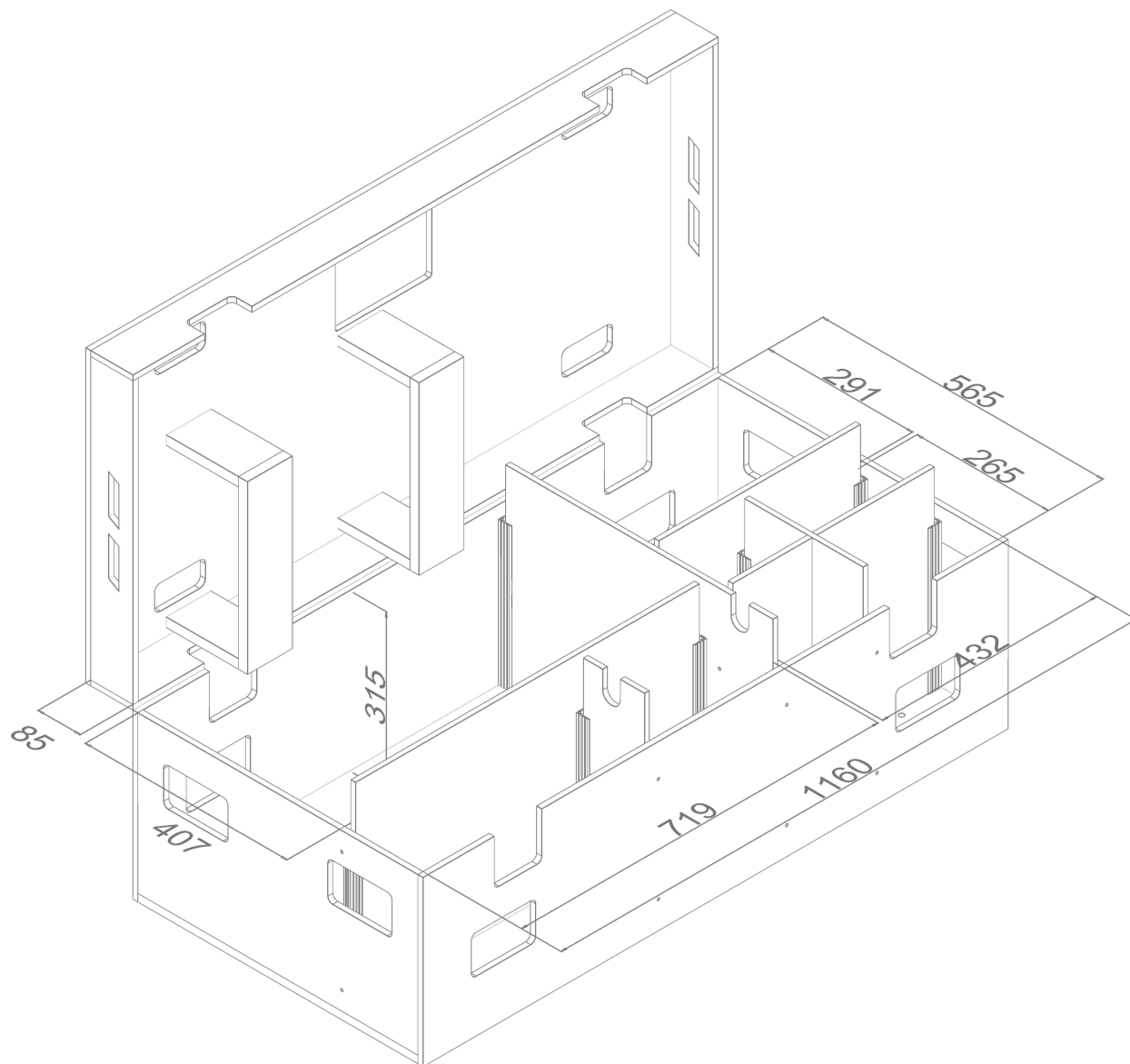

The presented dimensions are in [mm]

		Title:	
Date	05.12.2024.	MO-310 Case (8) Astera Quick Spot	
Drawn by.			
Checked			
Approved			
		Project ID:	760188986
		Scale:	
		Sheet:	F: A4
			31/32 L: 11

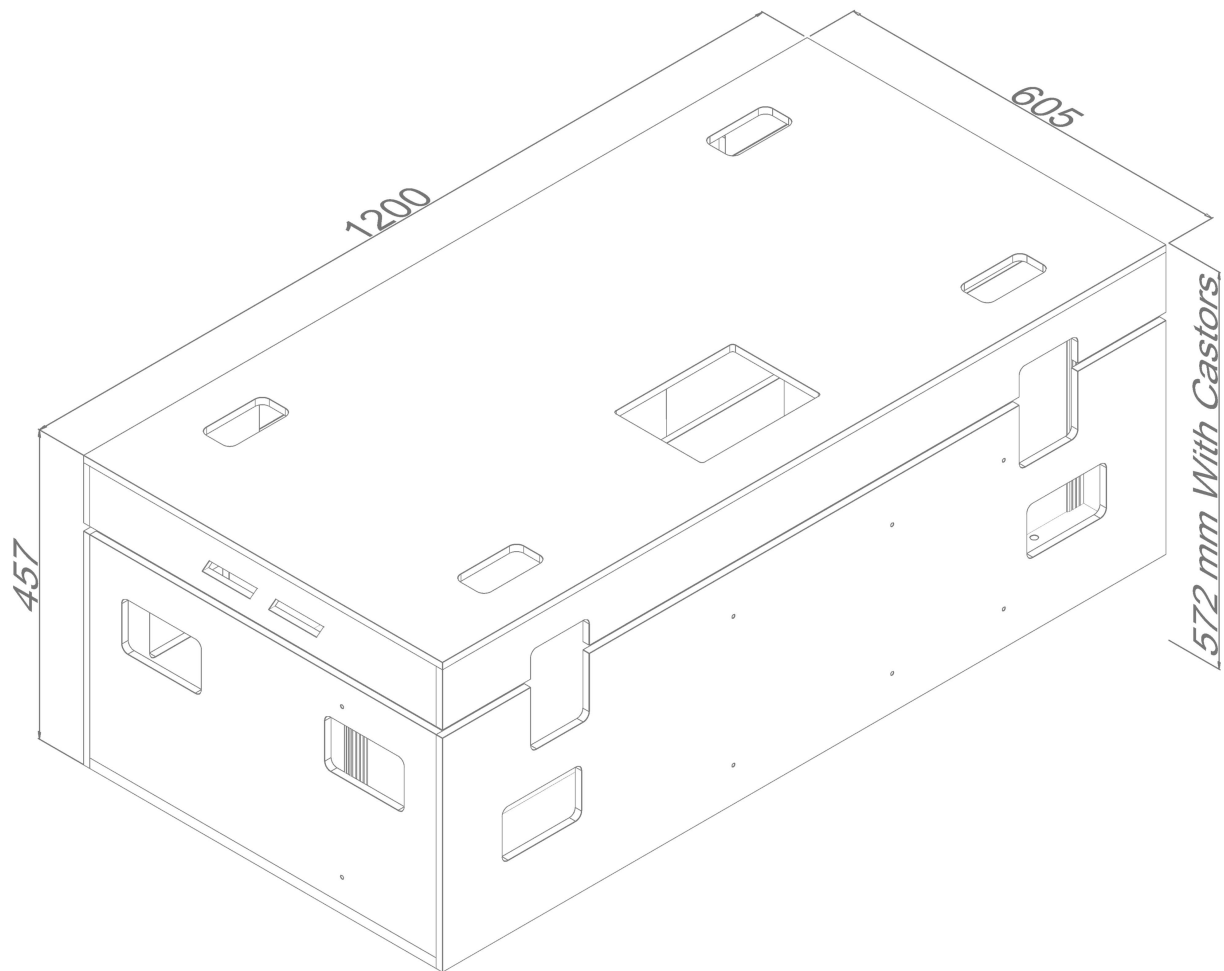

The presented dimensions are in [mm]
The Ball Corners are included

		Title:			
Date	05.12.2024.	MO-310 Case (8) Astera Quick Spot			
Drawn by.					
Checked					
Approved					
		Project ID:	760188986	Scale:	Sheet: F: A4 32/32 L: 11